

The Boxford

Roodhill – Boxford – Newbury – RG20 8DD

Premises licence plans

Included:

Location plan

Detailed plan of licensed areas and fire safety equipment

Position and types of portable fire safety equipment may change at any time due to ongoing risk-assessments and best practice

Any marks on these plans not specifically required under The Licensing Act 2003 (Premises licenses and Club Premises Certificates) Regulations 2005 are for information only and subject to change at any time

The consumption of alcohol shall be permitted in any area within the demise of the premises licence holder

- LICENSING AREAS**
- Site Boundary
 - Boundary of licenced premises
 - Licensable Activities
 - Non Licensable Activities
- FIRE**
- Manual call point
 - Smoke detector
 - Heat detector
 - Combined smoke detector sounder
 - Combined smoke detector sounder & xenon beacon
 - Combined heat detector and sounder
 - Combined heat detectors sounder and xenon beacon
 - 'FIRE DOOR KEEP SHUT'
 - Self Illuminating Fire exit signage
- Wall mounted combined sounder and xenon
 - Wall mounted sounder
 - Emergency lighting with 2 hour maintained system in accordance with BS 5266
 - Kitchen fire suppression system, fitted to extractor hoods and ductwork
 - Xenon beacon
 - Water (Hydrospray 13A Rating)
 - Foam
 - Carbon dioxide 2KG
 - Dry Powder
 - Wet Chemical
 - Fire Blanket
 - Fire alarm control panel
 - Intruder alarm keypad
 - Movement Sensor
 - Door Contact
 - Panic Button

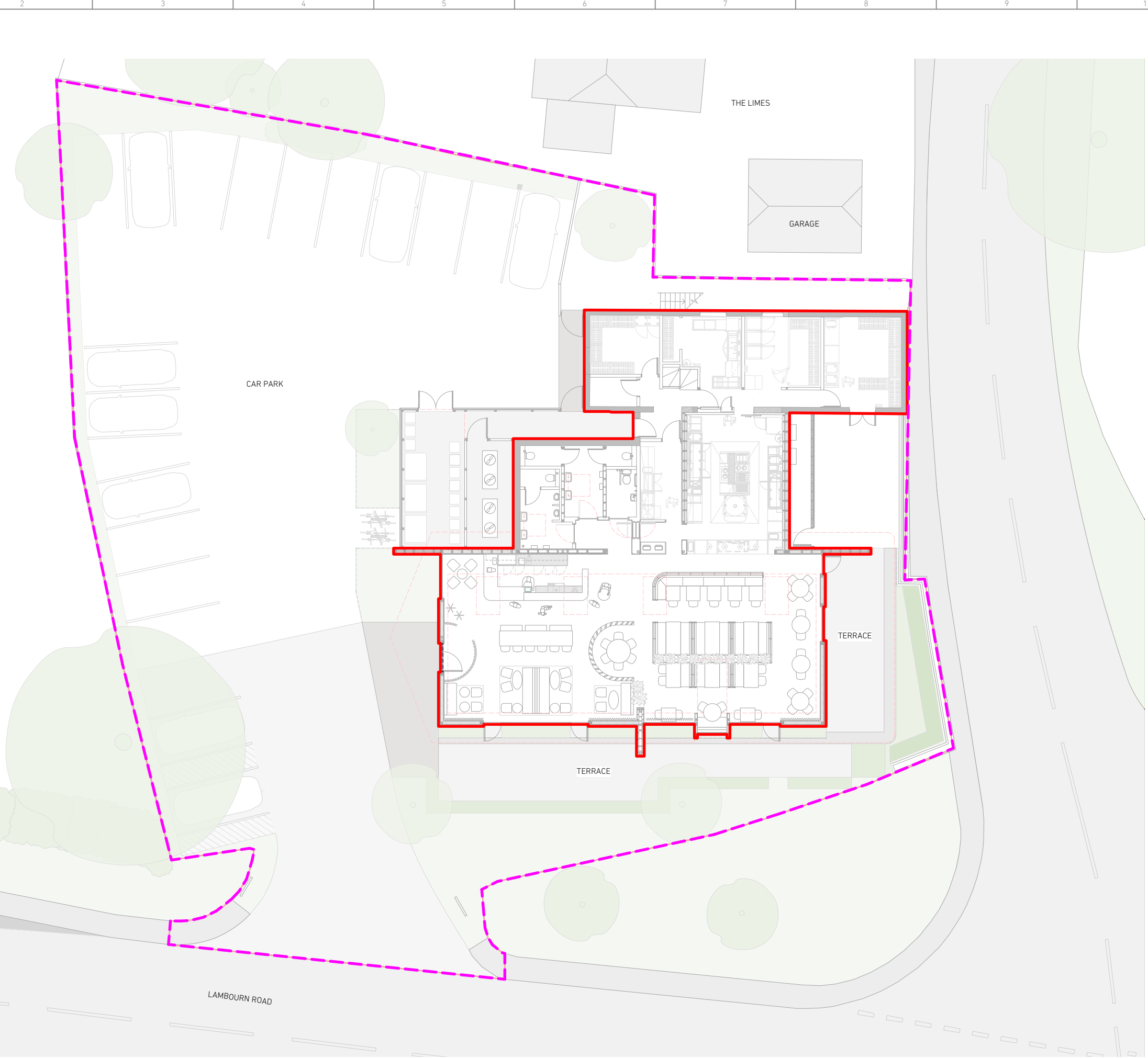

Chris Bagot_Architects

Studio 4, 6 - 8 Cole Street, London, SE1 4YH
 www.chrisbagotarchitects.com
 studio@chrisbagotarchitects.com
 +44 (0) 79708 26396

General Notes

A	18/08/23	LICENSABLE AREA AMENDED
REVISION	DATE	NOTES

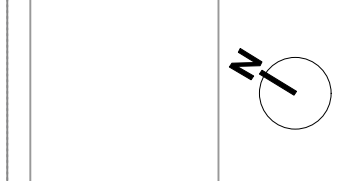

FOR	THE BELL PUB
PROJECT	BOXFORD PROJECT NO. 2101
STATUS	FOR INFORMATION
SCALE	1:100@A1 DATE 08/08/23
TITLE	SITE PLAN - LICENSING
DRAWING NO.	(01)00 REVISION A

LICENSING AREAS

- Boundary of licenced premises
 - Licensable Activities (246m²)
 - Non Licensable Activities (132 m²)
- FIRE**
- Manual call point
 - Smoke detector
 - Heat detector
 - Combined smoke detector sounder
 - Combined smoke detector sounder & xenon beacon
 - Combined heat detector and sounder
 - Combined heat detectors sounder and xenon beacon
 - FIRE DOOR KEEP SHUT
 - Self illuminating Fire exit signage

- Escape route
- Wall mounted combined sounder and xenon
- Wall mounted sounder
- Emergency lighting with 2 hour maintained system in accordance with BS 5266
- Kitchen fire suppression system, fitted to extractor hoods and ductwork
- Xenon beacon
- Water (Hydrospray 13A Rating)
- Foam
- Carbon dioxide 2KG
- Dry Powder
- Wet Chemical
- Fire Blanket
- Fire alarm control panel
- Intruder alarm keypad
- Movement Sensor
- Door Contact
- Panic Button



General Notes

REVISION	DATE	NOTES
C	21/06/23	BAR INCLUDED
B	21/06/23	FIRE EXTINGUISHERS ADDED
A	18/06/23	LICENSABLE AREA AMENDED

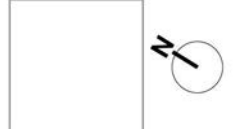

FOR	THE BELL PUB
PROJECT	BOXFORD PROJECT NO. 2101
STAGE	FOR INFORMATION
SCALE	1:50@A1 DATE 08/08/23
TITLE	GROUND FLOOR - LICENSING PLAN
REVISION NO.	(BC)04 REVISION C